

# SECTION DETAIL - EXTERNAL & INTERNAL SYSTEM (OPTION 2)

## CAVITY DRAIN MEMBRANE - WALLS

BLG GEO-TEX MEMBRANE + TWO COAT TECHNOSEAL PRIMARY (COMPRESSION RESISTANT) WATERPROOFING PRODUCT TO BE APPLIED PRIOR TO INSTALLING THE MEMBRANE

EXTERNAL LAND DRAIN - AQUA DRAIN PERFORATED DRAINAGE SURROUNDED BY PEA GRAVEL AND GEO-TEXTILE

SERVICEABLE VIA INSTALLATION OF UPSTAND / FLUSH PIPES.

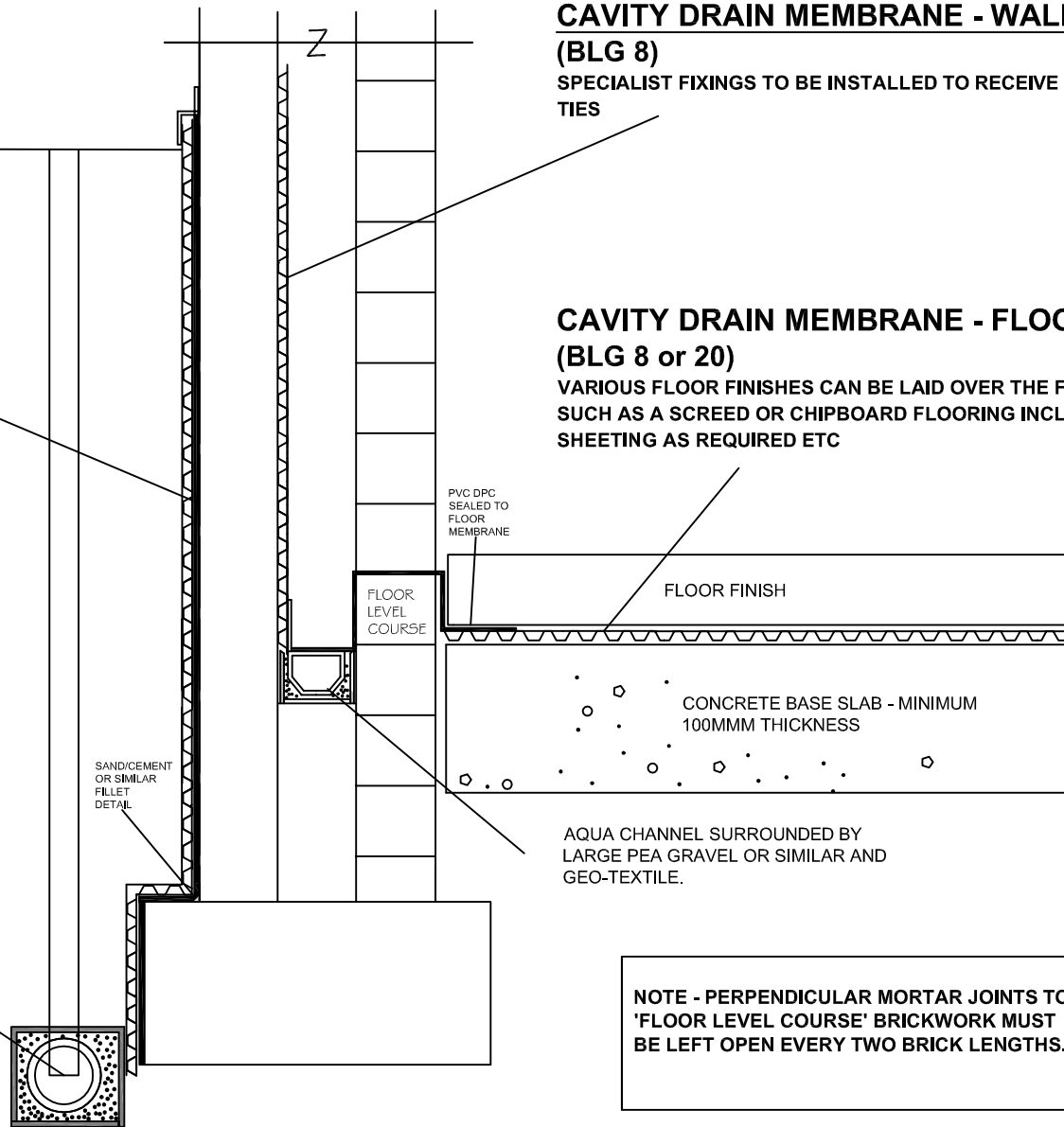

## CAVITY DRAIN MEMBRANE - WALLS (BLG 8)

SPECIALIST FIXINGS TO BE INSTALLED TO RECEIVE 'SCREW TYPE' WALL TIES

## CAVITY DRAIN MEMBRANE - FLOORS (BLG 8 or 20)

VARIOUS FLOOR FINISHES CAN BE LAID OVER THE FLOOR MEMBRANE SUCH AS A SCREED OR CHIPBOARD FLOORING INCLUDING INSULATION SHEETING AS REQUIRED ETC

NOTE - PERPENDICULAR MORTAR JOINTS TO 'FLOOR LEVEL COURSE' BRICKWORK MUST BE LEFT OPEN EVERY TWO BRICK LENGTHS.

