

SECTION DETAIL - NEW INTERNAL WALL SEALING / CONTINUITY

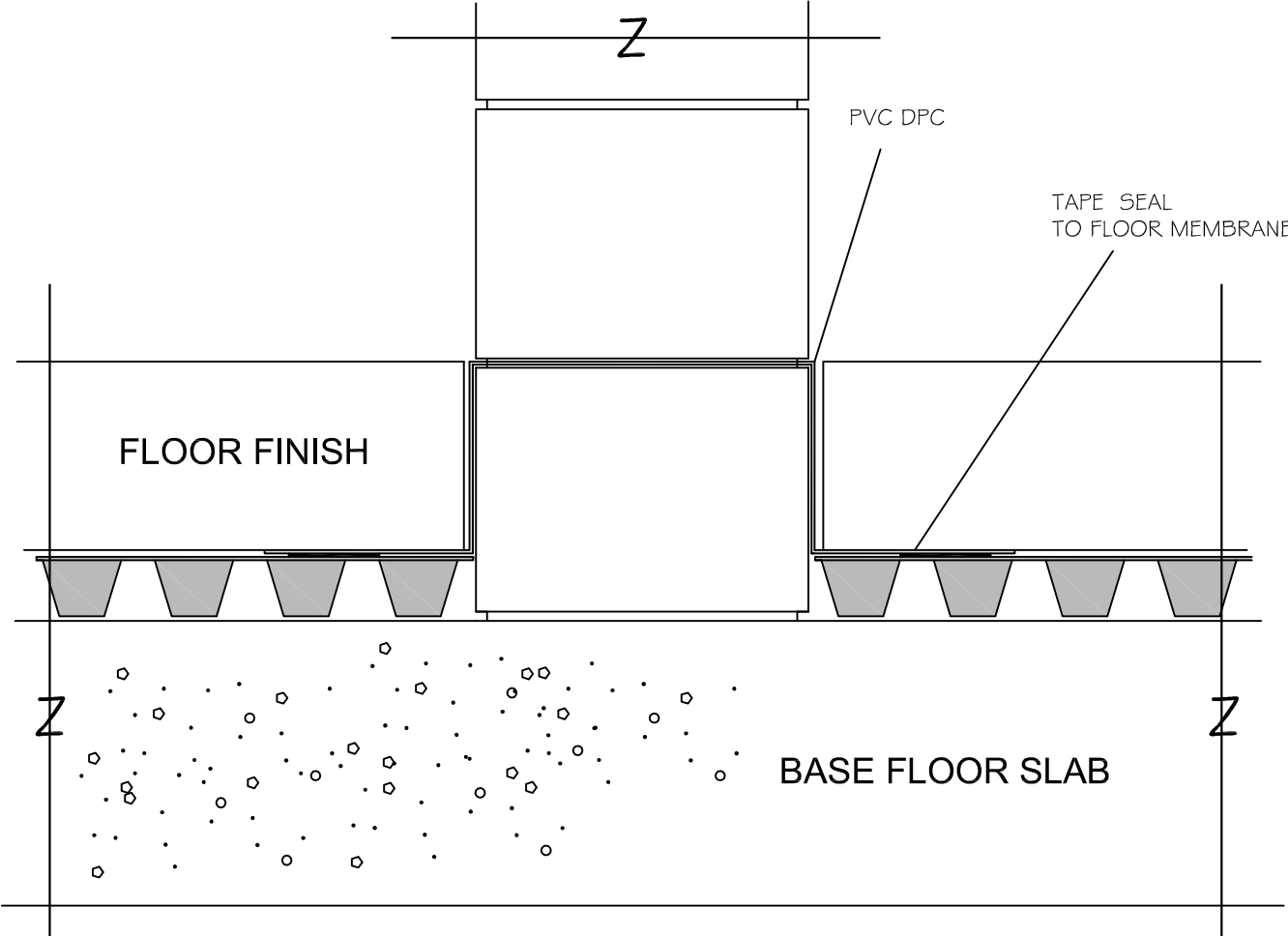

NOTE - PERPENDICULAR MORTAR JOINTS TO BASE COURSE BRICKWORK MUST BE LEFT OPEN EVERY TWO BRICK LENGTHS. THIS SPECIFICATION IS BASED UPON THE INTERNAL WALL NOT REQUIRING A MEMBRANE DUE TO THE WALL EITHER BEING FULLY ISOLATED OR UNCONNECTED TO ANY GROUND RETAINING WALLS.

